

SPECIFICATION

Planting

Plants are to be supplied true to type free from disease, pests and in a vigorous well developed condition without being root bound. All plants are to receive osmocote 9 mths slow release fertilizer applied according to manufacturers recommended rates. All trees, shrubs and groundcovers are to receive Water Storage Crystals to there root zone area at planting time, refer to manufacturers application rates. Trees are to be staked as indicated and all plants are to be flood watered in there pots prior to planting and within 30 mins after planting. Variations to the plant species and size due to lack of availability are to be discussed with the landscape consultant before any alterations may take place.

Soil Mix

Natural ground soil mix shall consist of the following :
3 parts by volume imported top soil ,1 part by volume double washed river sand, 1 part by volume friable spent mushroom compost.
Planter Boxes on concrete decks :
30% black top soil, 10% graded ash, 10% double washed river sand, 20% composted hardwood sawdust, 20% composted friable mushroom compost, 10% composted pinebark
Thoroughly mix all ingredients to acheive a pH 6.5

Mulch

Wood & leaf chip mulch is to be spread to a depth of 75mm, blanket cover to all garden beds located on natural ground. Cowra white gravel with particle size no greater than 15mm Dia. is to be spread to a depth of 60mm blanket cover to all brick planter boxes.

Brick Edges

Brick edges are to be constructed on a 75mm depth mortar footing with a 10mm joint. Bricks are to be full bricks, type and colour to be decided.

Turfing

Turf specified is to be cultivated Kikuyu from an approved turf grower. See turfing details. Turf shall be free from pests, diseases and weeds. Turf is to be laid within 24hrs of lifting. Lay turf with closed butted joints and water thoroughly each section after laying. Top dress joints with one part washed river sand and one part top soil to achieve an even surface free from hollows and ruts. Fertilize the turf with an approved turf fertilizer eg. Shirleys # 18 lawn food and continue to water turf to prevent burning.

Irrigation

Automatic drip-feed irrigation is to be installed to all garden beds and planters. Netafim tech-line '16' or similar product is to be installed prior to mulching and fixed to the soil surfaces with wire 'U' pegs at 1m intervals to prevent drip line from lifting. Automatic flush valves, air relief valves and filters are to be installed and drip spacings of 300mm are recommended. The drip tubes are to be placed as close as possible to the base of each plant. Back-flow prevention valves are to be installed according to the water Boards regulations concerning irrigation systems. The irrigation contractor is responsible for the maintenance of the irrigation system for the entire 26 week maintenance period. This will entail 3 monthly visits to check watering frequency or adjust watering requirements where there appears a need for reduction or additional watering of specific areas where necessary to maintain optimum plant growth.

Maintenance

The landscape contractor is to maintain the site in its entirety for a period of 26 weeks from the date of practical completion. This is to include maintenance on a weekly basis for a period of 3 months, afterwards fortnightly thereafter for the remainder of the maintenance period.

The maintenance period shall include the following items :
Ensure there is sufficient soil moisture in all garden beds and planter boxes to sustain optimum plant growth. Plants shall be inspected by the contractor on a fortnightly basis and any plant that has died or is failing to thrive shall be replaced at the contractors own expense, at the next inspection. Replacement of plants are to be carried out with plants of the same genus, species and container size. The contractor is not held responsible for plants that are subject to vandalism or theft. However, the contractor is to notify the landscape consultant prior to any plant replacements or variations to the contract. Spraying to control pests and diseases is to be carried out by a certified person. Top up any mulched areas to attain a depth of 75mm and reinstate and repair any erosion or subsidence which may occur. Rectify any defects or faults that may arise due to failure of materials or workmanship.

O.H & S

The landscape contractor and his staff must have an up to date Occupational Health and Safety General Induction Card for construction work in NSW.

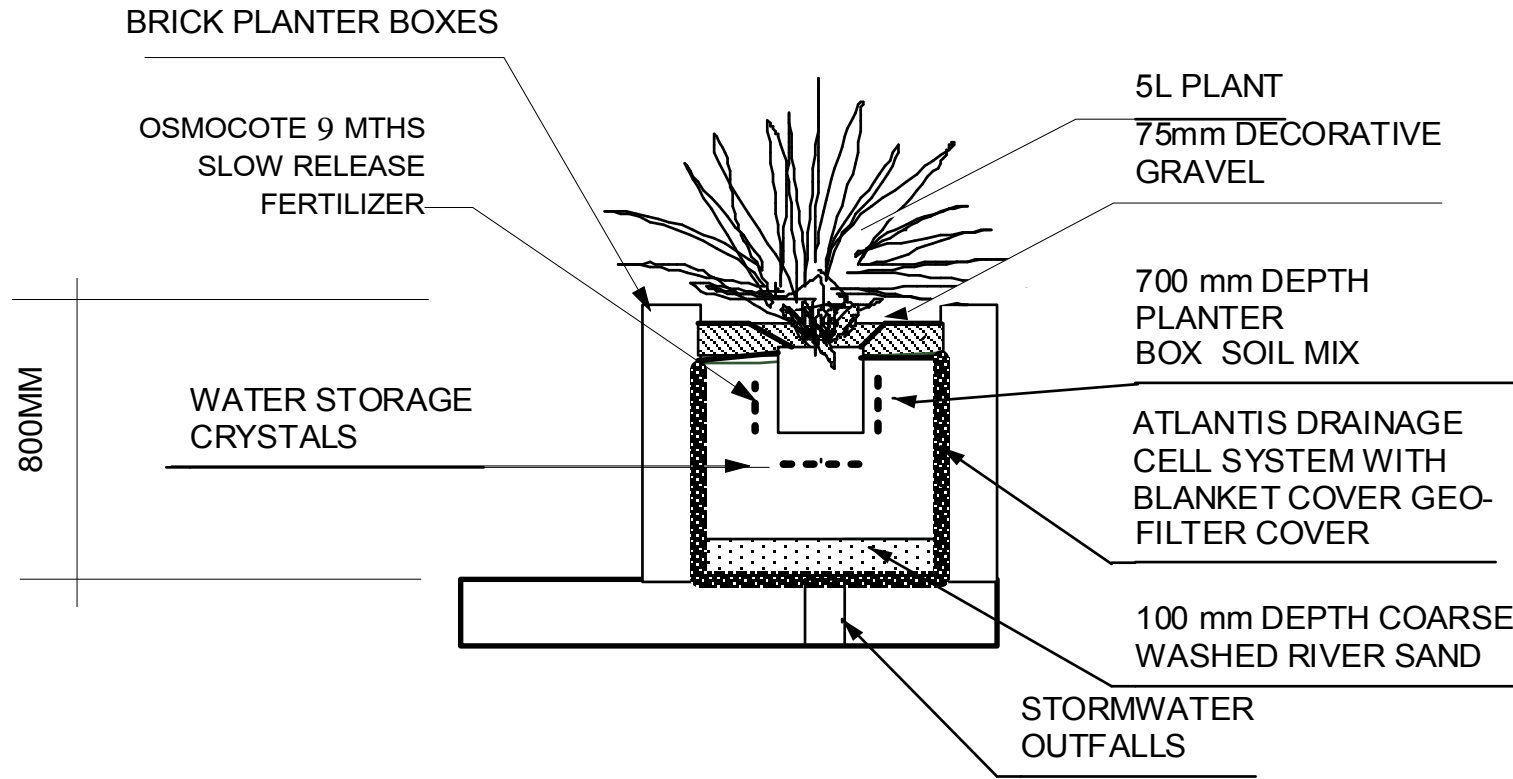

PLANTING DETAIL ON CONCRETE DECKS

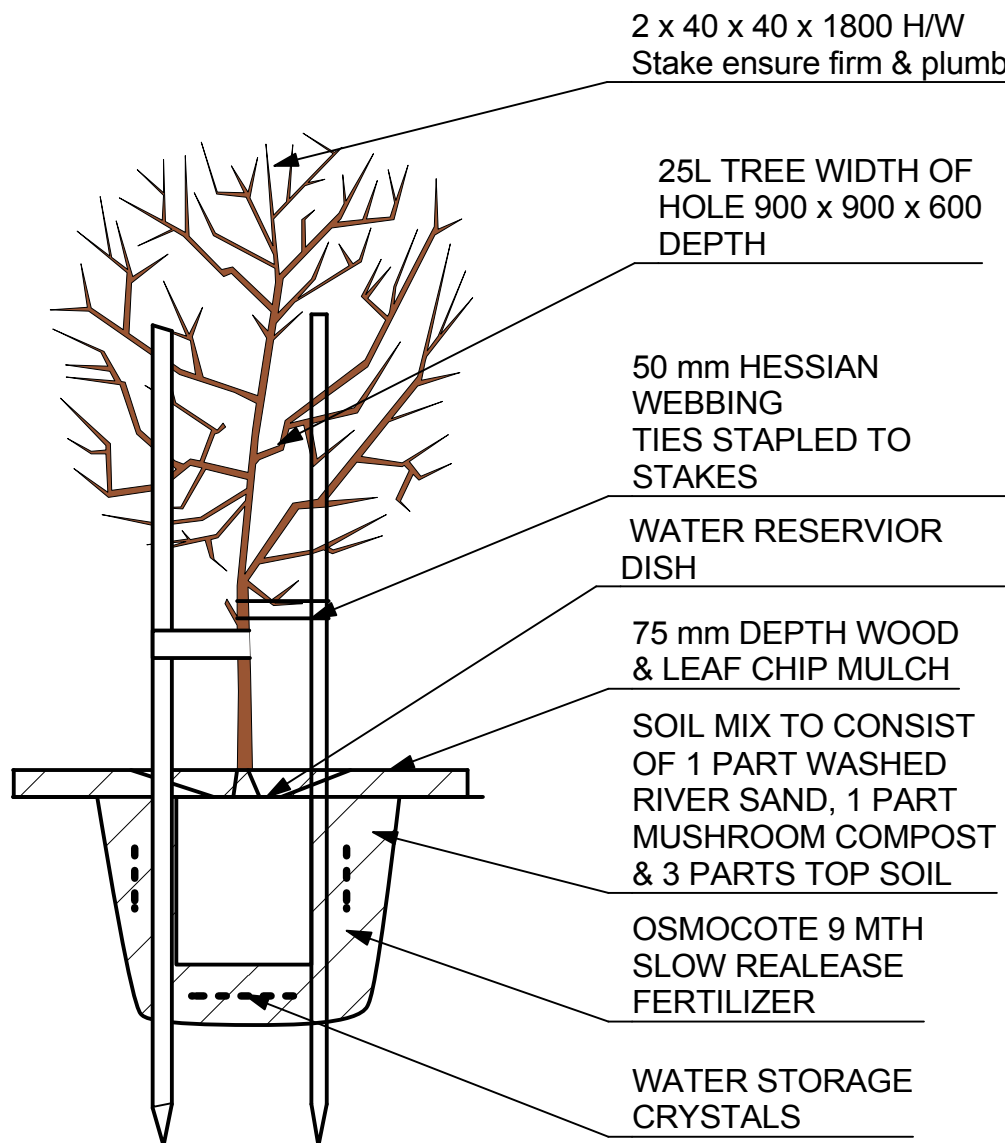

TREE PLANTING DETAIL
25L & 75L

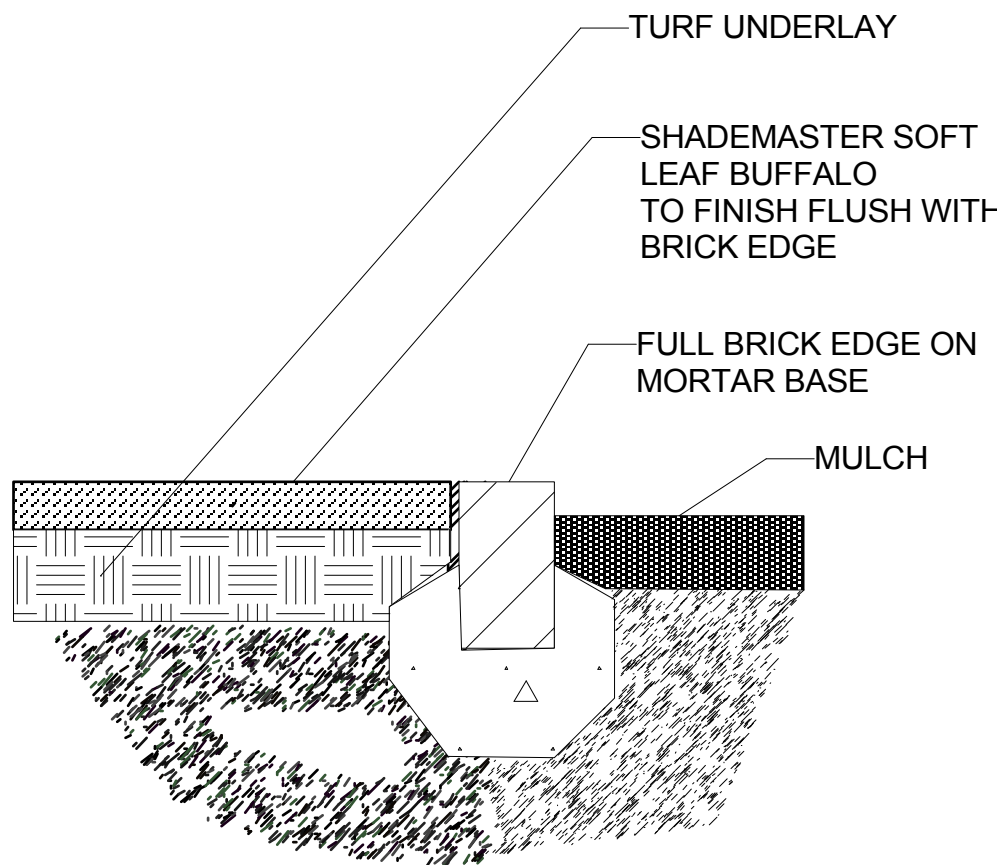

BRICK EDGE DETAIL

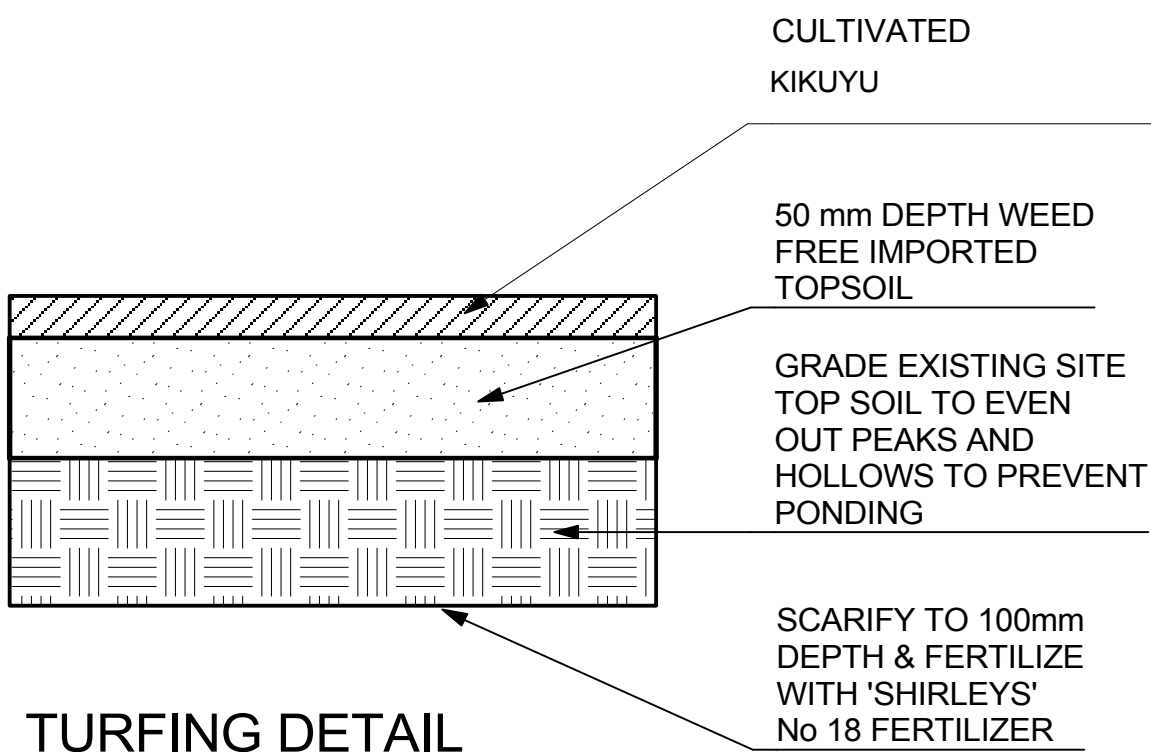

TURFING DETAIL

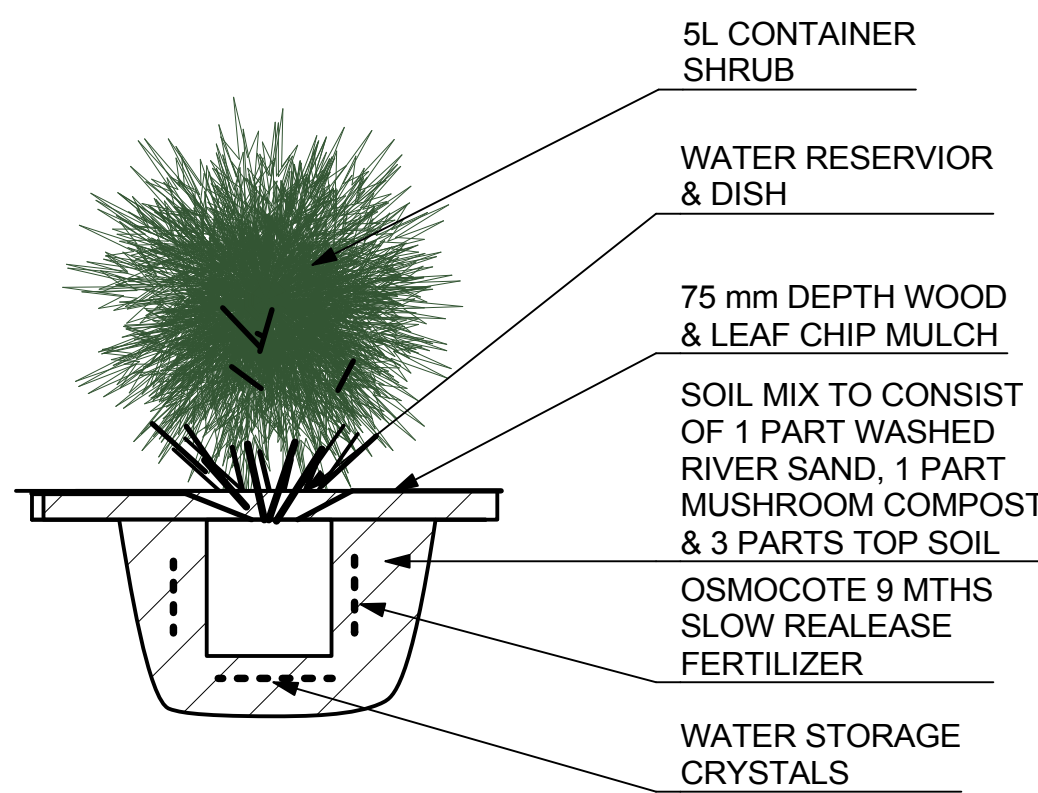

SHRUB PLANTING DETAIL

LANDSCAPE PROPOSAL
DETAIL SHEET

BUCASIA PTY LTD
62-80 ROWE STREET,
EASTWOOD, NSW

ULP URBAN LANDSCAPE PLANNERS P/L

Landscape, Horticulture & Vegetation Consultants
Terrence Machin MAILDM & MAIH
20 Koorana Road, Picton NSW, 2571

DATE : 18/10/2008
SCALE :
DWG # : 001846/TM | SHEET 2-2